

www.accutroninstruments.com

# COMMTRAX™

## PORT FORWARDING PROTOCOL CONVERTER



CommTRAX is a compact protocol converter that acts as a server, collecting data from various MODBUS RTU devices and distributing it at a low Bandwidth within a single register package.

The Modbus TCP port can operate as both client and server (master and slave). In addition, CommTRAX can use threshold rule templates to continuously monitor modbus data and generate SNMP Traps upon sensing "alarm" conditions. As a Modbus to Modbus gateway, CommTRAX can map multiple RTU devices to a single Modbus TCP server map.

More than just a protocol converter.

## CONSOLIDATE MODBUS REGISTERS IN ONE PACKAGE AND SAVE BANDWIDTH. POLL INSTRUMENTATION DATA EFFICIENTLY.

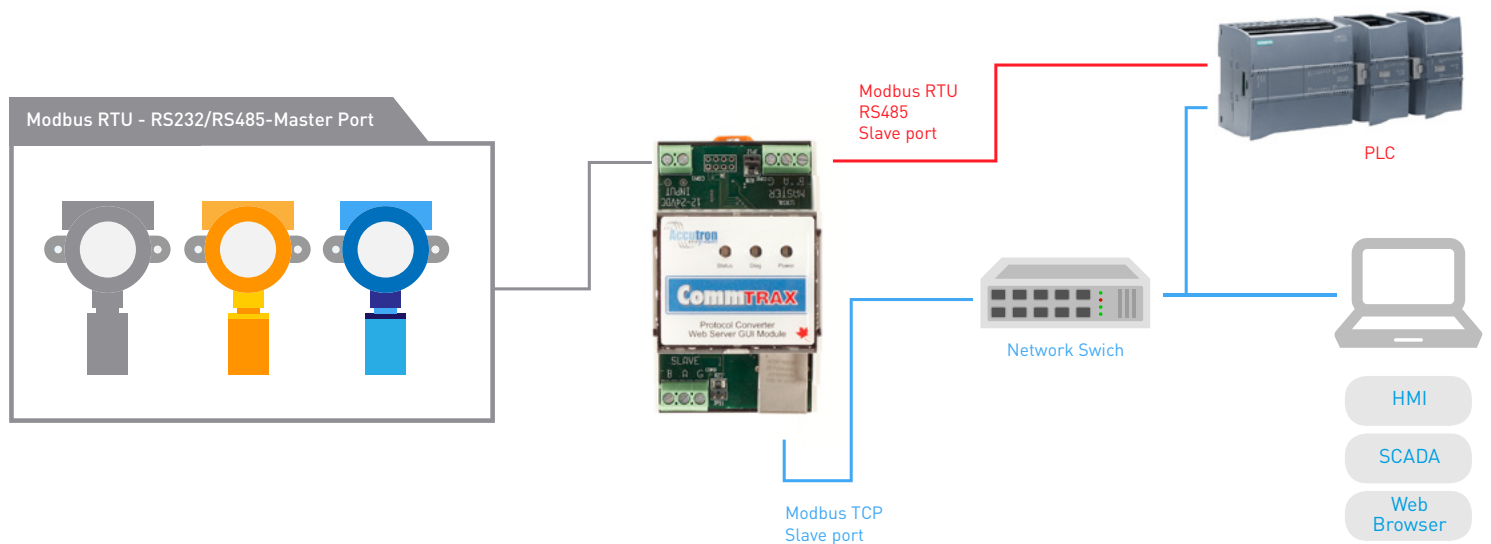

## THE COMMTRAX IS AN ALL-IN-ONE REMOTE MONITORING SOLUTION

Designed to provide employees and management with the information they need to make better decisions more quickly. Using only one device with built-in automation features, Maintenance Staff, Network Operators and Safety Committees can pull data from any type of critical infrastructure.

**CommTRAX integrates with existing fault management process and management software.**

✓ Works with an intuitive web-based interface to see site conditions anywhere, any time using your smartphone, tablet or computer

- ✓ Measures, calculates and provides real-time Key Performance Indicators. Such as AC Mains, UPS, Generator and HVAC utilization levels, Rectifier, UPS, Inverter efficiency levels and site Facility Power Usage Effectiveness as well as Data Center Infrastructure Efficiency (DCIE)
- ✓ LiveScript allows the use of mathematical equations and logic
- ✓ Smart alarm messages are transmitted via email, SNMP traps, text messages, and more
- ✓ Compatible with management software, automation software, PLCs and applications supporting SNMP communication

## BENEFITS

- ✓ Eliminates the need for PLCs, multiple RTUs, monitoring and metering devices
- ✓ Can communicate with multiple Modbus devices via multiple Modbus interfaces
- ✓ Outstanding reporting capabilities, built-in charting tools, and powerful monitoring software
- ✓ Provides a multitude of monitoring applications in one simple and reliable integrated solution



## Reduces CapEx Investments by

- ✓ Integrating all remote monitoring and control needs into a single product
- ✓ Reducing the number of sensors and probes installed at a site to eliminate duplication, confusion and possibly conflicting data to provide accurate readings
- ✓ Reducing the planning cycle time by having the AC Mains, UPS, Generator and HVAC utilization levels pre-calculated to provide trend analysis information

## Software Features

- ✓ Powerful web-based interface to see site conditions any where, any time
- ✓ LiveScript, micro php Accutron Discovery Technology
- ✓ Real-time register polling
- ✓ Remote and local firmware upgrades and diagnostics (SD upgradable)
- ✓ Simple integration with existing fault management process and management software
- ✓ Alarm notification through email, SNMP, text, and more

## Protocols

- ✓ TCP/IP; HTML, TFTP
- ✓ SNMP
- ✓ Modbus (RS485): Modbus Master/Slave; RTU mode;
- ✓ Modbus TCP/IP. Modbus Master/Slave; TCP/IP transmission protocol
- ✓ Modbus RTU RS-485 or RS-232
- ✓ Modbus TCP over Ethernet 10/100Base

## Accessories

- ✓ TRAXBus (din rail communication modules)
- ✓ TRAX Connectors
- ✓ Micro SD
- ✓ CommTRAX web-based application
- ✓ IOTRAX expansion

# SPECIFICATIONS

<b>Electrical Ratings</b>	<b>Power In</b>	<b>Power Consumption</b>	<b>Impedance</b>
	12-24VDC	3 mW	120 $\Omega$
<b>Communication Interface</b>	<b>Inputs</b>	<b>Outputs</b>	<b>Protocols</b>
	RS232, RS485	RS232, RS485	Modbus RTU Modbus TCP SNMP
<b>Physical</b>	<b>Enclosure</b>	<b>Mouting</b>	<b>Operating temperature</b>
	9 cm X 6.2 cm X 5.3 cm	DIN rail mounted (35mmx 7.5mm)	-40°C to +80°C



☎ 705.682.0814  
📠 705.682.2215  
✉ info@accutroninstruments.com  
🌐 www.accutroninstruments.com

